

# RURAL MUNICIPALITY No 218

## CUPAR W.O.F 2ND

SCALE: 1 IN. = 1 MI.

- URBAN MUNICIPALITIES
- SCHOOLHOUSES
- POST-OFFICE
- CHURCHES
- CEMETERIES
- RAILWAYS
- PROVINCIAL HIGHWAY
- GOVERNMENT BRIDGES

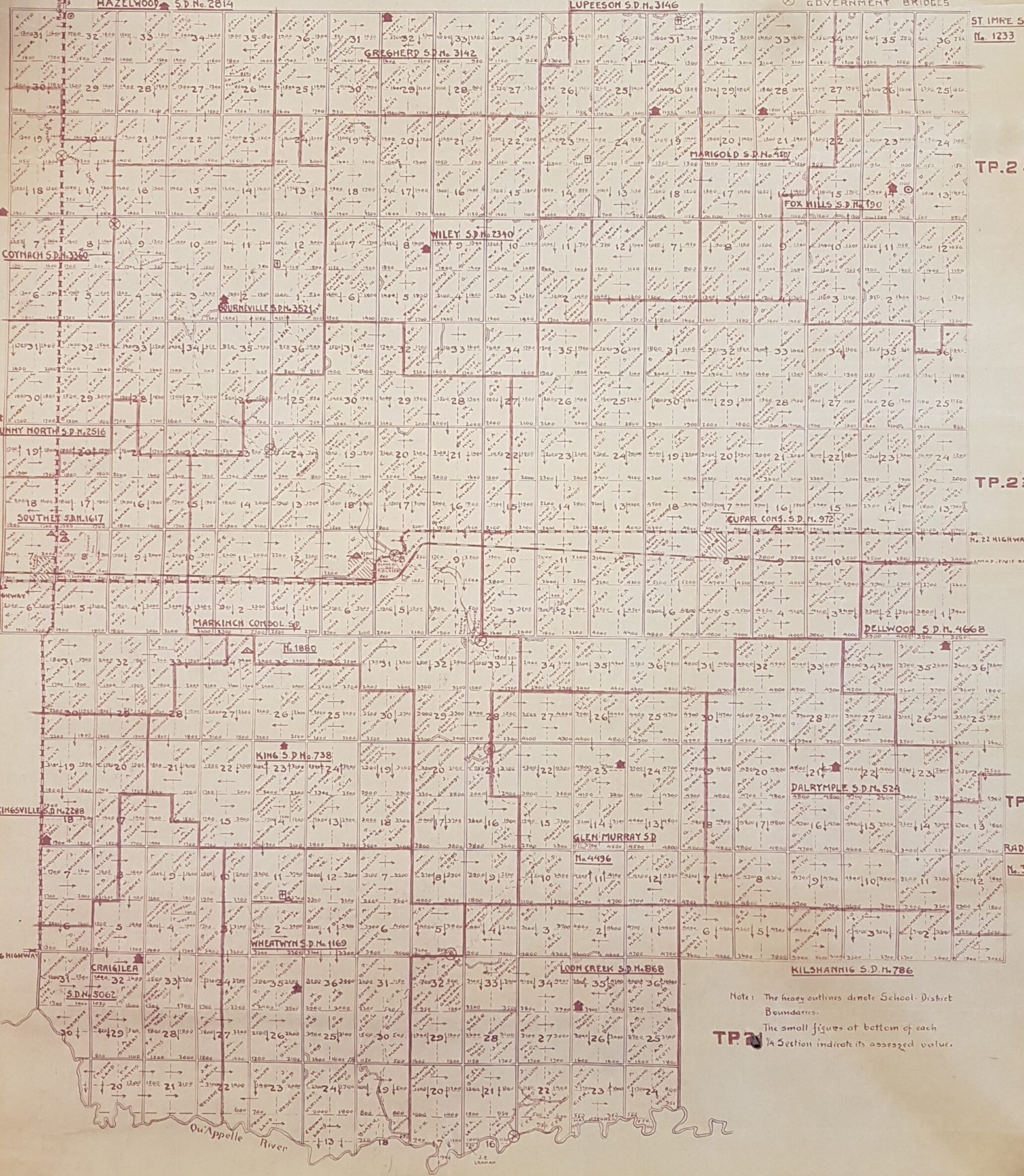

Note: The heavy outlines denote School-District Boundaries.  
The small figures at bottom of each Section indicate its assessed value.